

**SPECIFIC PLAN AMENDMENT
CITY OF ROSEVILLE, CA**

PC EXHIBIT A

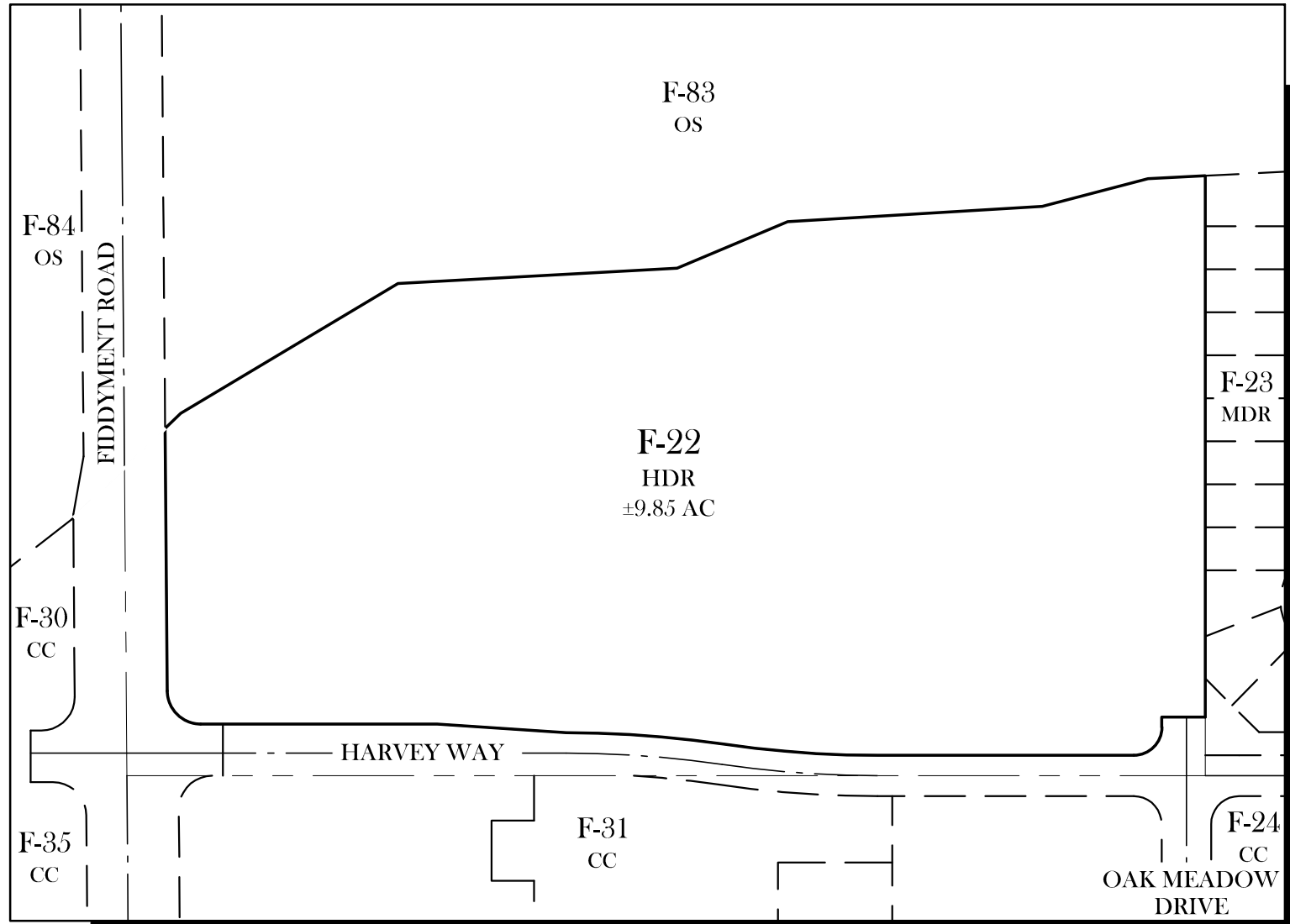

EXISTING

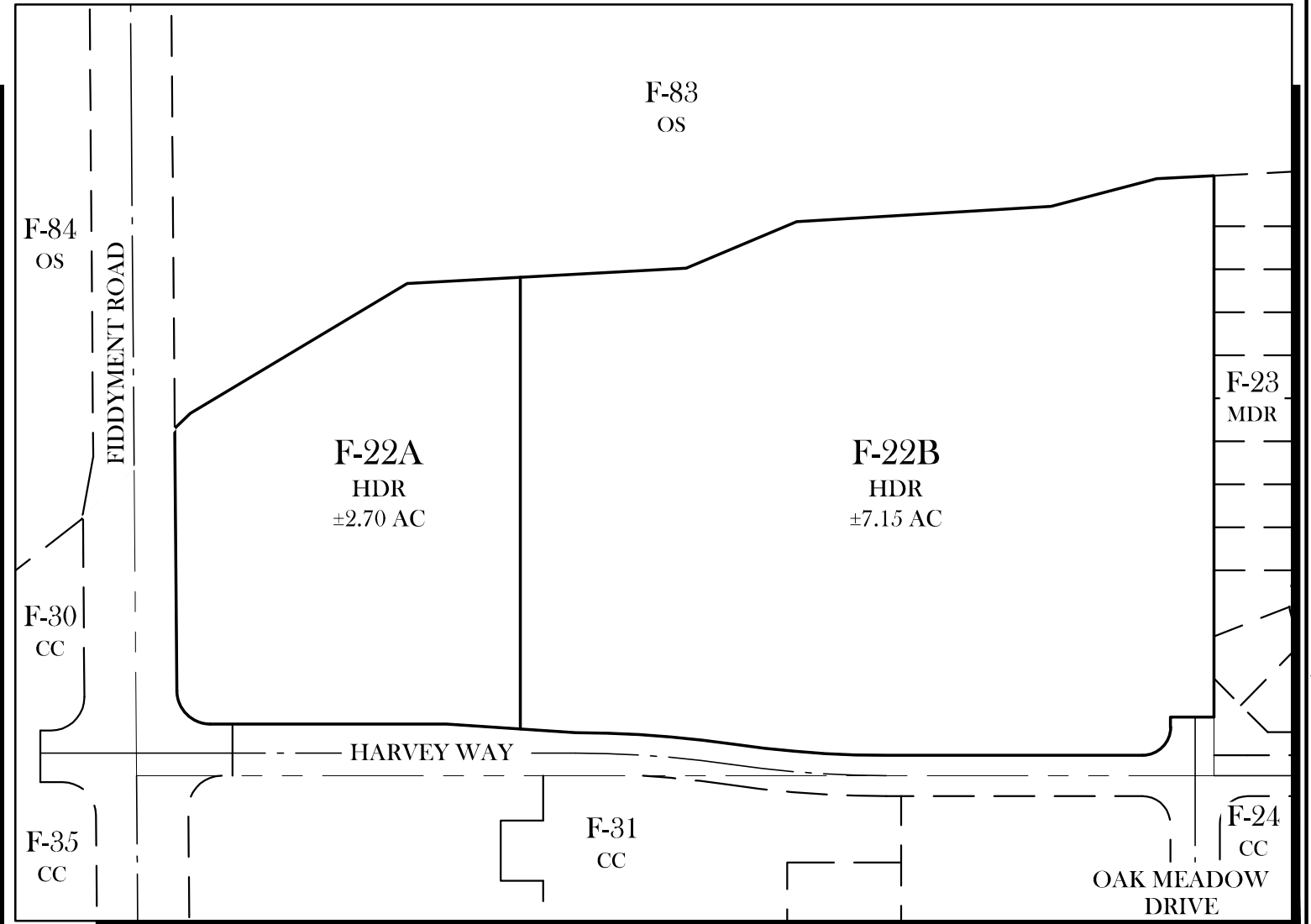

PROPOSED

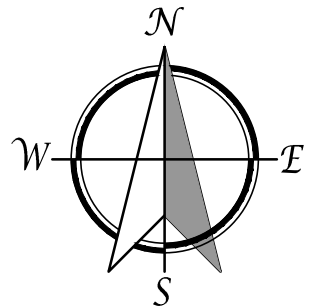

scale: 1"=150'

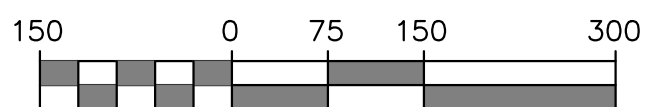

PARCEL NO.	LAND USE	EXISTING ACRES	PROPOSED ACRES
F-22	HIGH DENSITY RESIDENTIAL	9.85	0
F-22A	HIGH DENSITY RESIDENTIAL	0	2.70
F-22B	HIGH DENSITY RESIDENTIAL	0	7.15
TOTALS		9.85	9.85

SPECIFIC PLAN AMENDMENT
JULY 25, 2022

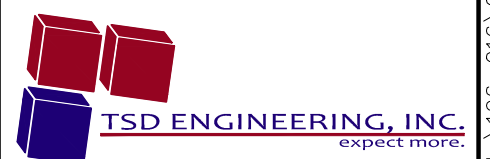

785 Orchard Drive, Suite #110
Folsom, CA 95630
Phone: (916) 608-0707
Fax: (916) 608-0701